

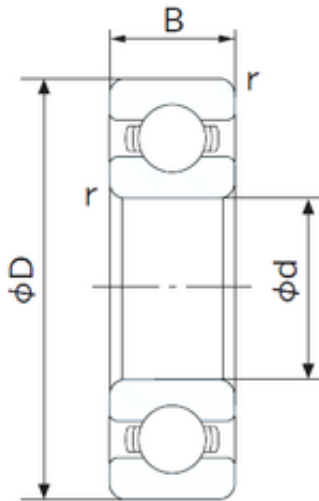

# SRS PRECISION AXLE CORP.



6311 2RS - O&Kai Z1V1 Z2V2 Z3V3 Deep Groove Ball Bearing SKF NSK NTN NACHI Koyo FAG OEM

Bearing No. 6311

6311 Bearing 2D drawings and 3D CAD models

Size	55x120x29 mm
Bore Diameter	55 mm
Outer Diameter	120 mm
Width	29 mm
d	55 mm
D	120 mm
B	29 mm
C	29 mm
r min.	2 mm
da min.	65 mm
Da max.	110 mm
ra max.	2.0 mm
Weight	1.37 Kg
Basic dynamic load rating (C)	71,5 kN
Basic static load rating (C0)	44,5 kN
(Grease) Lubrication Speed	5600 r/min
Category	Single Row Ball Bearings
Inventory	0.0
Manufacturer Name	NACHI
Minimum Buy Quantity	N/A
Weight / Kilogram	0
Product Group	B00308
Enclosure	Open
Precision Class	ABEC 1   ISO P0



## SRS PRECISION AXLE CORP.

Maximum Capacity / Filling Slot	No
Rolling Element	Ball Bearing
Snap Ring	No
Internal Special Features	No
Cage Material	Steel
Internal Clearance	C0-Medium
Inch - Metric	Metric
Long Description	55MM Bore; 120MM Outside Diameter; 29MM Outer Race Width; Open; Ball Bearing; ABEC 1   ISO P0; No Filling Slot; No Snap Ring; No Internal Special Features; C0-Medium Internal Clearance; Steel Cage
Other Features	Deep Groove
Category	Single Row Ball Bearing
UNSPSC	31171504
Harmonized Tariff Code	8482.10.50.68
Noun	Bearing
Keyword String	Ball
Manufacturer URL	<a href="http://www.nachiamerica.com">http://www.nachiamerica.com</a>
Outer Race Width	1.142 Inch   29 Millimeter
Bore	2.165 Inch   55 Millimeter
Inner Race Width	0 Inch   0 Millimeter
Outside Diameter	4.724 Inch   120 Millimeter
Bore Type	Cylindrical Bore
Configuration	Single Row
Bore Size	55 mm
Width	29 mm
Fillet Radius/Chamfer	2 mm
Dynamic Load Rating	71,500 N



## SRS PRECISION AXLE CORP.

Static Load Rating	44,500 N
Limiting Speed - Grease	5,800 rpm
Limiting Speed - Oil	6,800 rpm
Factor $f_0$	13.1
Radial Clearance	0.008 to 0.028 mm
da (min)	65 mm
Da (max)	110 mm
ra (max)	2 mm